

Series **V-5000** | Single Wrap

To handle single 1-1/2" I.D. through 3" I.D. hose.

- Effortless and fast rewinding, wrapping of hose.
- Chain and sprocket drive powered by electric, hydraulic, or compressed air motor.
- Auxiliary crank rewind, optional.
- 12 volt rewind, comet brake, reduction unit standard.
- Air brake optional.
- Inlet, hub assembly is aluminum.

Series V-5100

- Standard inlet: 90° ball bearing swivel joint, 1-1/2" female NPT threads, 2" Victaulic® groove, flanged riser with 1-1/2" female NPT threads.
- Standard pressures to 600 psi (41 bar).
- Standard fluid temperatures from -20° F to +212 °F (-29° C to +100° C).
- Consult factory for other pressures, temperatures, and options.

Series V-5200

- Standard inlet: 90° ball bearing swivel joint, 2" Victaulic® groove, flanged riser with 2" female NPT threads.
- Standard pressures to 150 psi (10 bar).
- Standard fluid temperatures from -20° F to +212 °F (-29° C to +100° C).
- Consult factory for other pressures, temperatures, and options.

Series V-5300

- Standard inlet: I-hub (aluminum only) straight 3" Victaulic® groove inlet, flanged riser with 3" female NPT threads.
- Standard pressures to 150 psi (10 bar).
- Standard fluid temperatures from -65° F to +180 °F (-54° C to +82° C).
- Optional 90° ball bearing alum swivel joint, 3" Victaulic® groove, flanged riser with 3" female NPT threads.
- Optional I-hub joints are available in:
 - 3" 90° ASA Flanged
 - 3" 90° Victaulic®
- Consult factory for other pressures, temperatures, and options.



Series V-5300
Standard configuration shown



Standard straight I-hub
for Series V-5300



90° Victaulic® version I-hub assembly
with riser for Series V-5300

PARTS DRAWING – ISO 197

Model Number For Power Rewind see Note 2	Hose Capacity of Reel feet m					Approx. Weight lb. kg		Reel Dimensions*** in. mm									
	I.D. in. mm	1-1/2 38	2 51	2-1/2 64	3 76	NET	SHIP	A	B	C	E	F POWER	F POWER with I-Hub	G	H	X	Y
	O.D. in. mm	2.06 52	2.67 68	3.25 83	3.78 96												
V-5111-48-50-20	50	-	-	-	-	310	385	10.63	2.5	20	48	17.5	-	50	26	8.63	28
	15	-	-	-	-	141	175	270	64	508	1219	445	-	1270	660	219	711
V-5111-56-58-20	75	-	-	-	-	330	405	10.63	2.5	20	56	17.5	-	58	30	8.63	28
	23	-	-	-	-	150	184	270	64	508	1422	445	-	1473	762	219	711
V-5111-62-64-20	100	-	-	-	-	340	415	10.63	2.5	20	62	17.5	-	64	33	8.63	28
	30	-	-	-	-	154	188	270	64	508	1575	445	-	1626	838	219	711
V-5218-56-58-24	-	50	-	-	-	370	445	11.5	3.63	24	56	19.25	-	58	30	9.5	28
	-	15	-	-	-	168	202	292	92	610	1422	489	-	1473	762	241	711
V-5218-62-64-24	-	75	-	-	-	390	465	11.5	3.63	24	62	19.25	-	64	33	9.5	28
	-	23	-	-	-	177	211	292	92	610	1575	489	-	1626	838	241	711
V-5218-70-72-24	-	100	-	-	-	400	475	11.5	3.63	24	70	19.25	-	72	37	9.5	28
	-	30	-	-	-	181	215	292	92	610	1778	489	-	1829	940	241	711
V-5319-62-64-30	-	-	50	50	-	400	475	12.25	4.38	30	62	21.25	20.5	64	33	10.25	28
	-	-	15	15	-	182	216	311	111	762	1575	540	521	1626	838	260	711
V-5319-70-72-30	-	-	75	-	-	410	485	12.25	4.38	30	70	21.25	20.5	72	37	10.25	28
	-	-	23	-	-	186	220	311	111	762	1778	540	521	1829	940	260	711
V-5319-78-80-30	-	-	100	-	-	420	495	12.25	4.38	30	78	21.25	20.5	80	41	10.25	28
	-	-	30	-	-	191	225	311	111	762	1981	540	521	2032	1041	260	711

Notes:

- Specifications subject to change.
 - When ordering power rewind models, prefix model number with:
 - V-A** = Air Rewind reels are supplied with control valve and 25" air hose.
 - V-EPJ** = Electric Rewind (2/3 HP) 12v and 24v DC rewind reels supplied with explosion proof switch, solenoid, and junction box.
 - V-HD** = Hydraulic Rewind reels are not supplied with control valve.
 - Be sure to check dimensions and weights prior to ordering.
- NOTICE:** A flexible connector must be used between the inlet pipe and the inlet swivel joint.
- ***X, Y indicate mounting holes. See page 2.

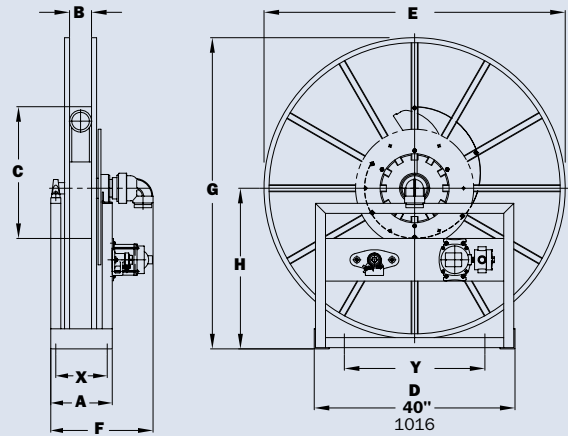

Series V-5100 and V-5200

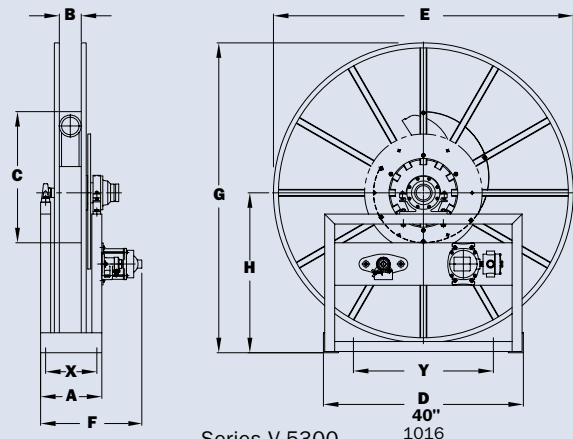

Series V-5300